

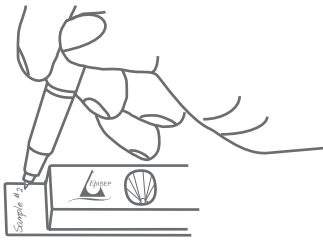

Getting Started - EpiSep HS[®] and EpiSep NSD II[®]

Step 1: Place EpiSep HS[®] on the EpiSep NSD II[®]



Write on the provided tab of the EpiSep HS[®] [Cat. # A3104-10]

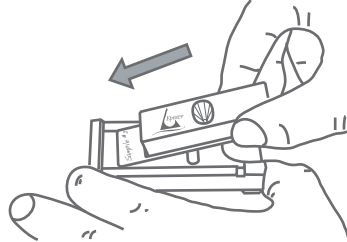

Slide the EpiSep HS[®] onto the EpiSep NSD II[®] [Cat. # A1103-1]

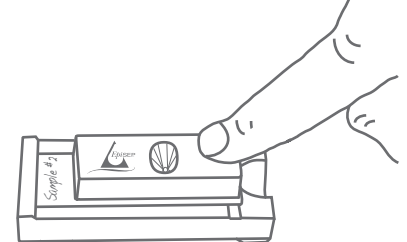

Verify that the EpiSep HS[®] is fully inserted

Step 2: Add Paramagnetic Antibody Labeled Specimen to EpiSep[®]

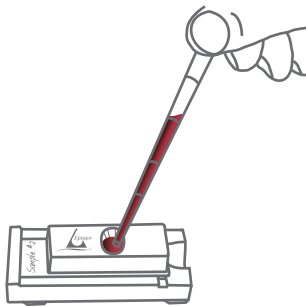

Add paramagnetic antibody labeled specimen to the EpiSep[®]

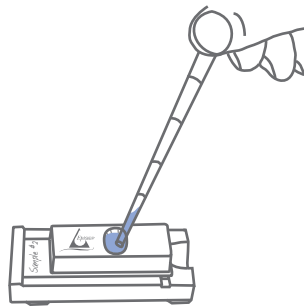

Add desired fixatives and stains [see tutorial relevant to your specimen]



Remove the EpiSep HS[®] Cap and allow fixative to dry

Step 3: Remove the Slide, Add Reagents, and Inspect the Specimen

Magnetic particles are visible in the center of the slide

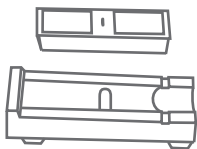

Remove the slide from the NSD II

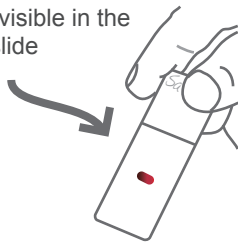

Add FISH Probes or other desired reagents

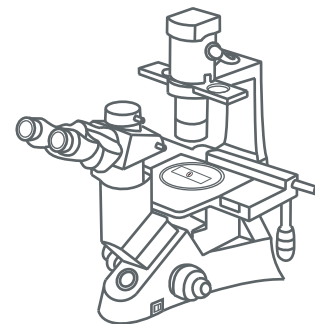

Inspect the Slide

15339 Barranca Pkwy • Irvine • CA • 92618 • USA
T: 800.807.7760 • F: 949.341.1982 • www.WaveSense.net

EpiSep is intended for research use only. Not for human or animal therapeutic use. EpiSep and WaveSense are trademarks of WaveSense Incorporated.

